



1011 WOODLANDS PARKWAY

The Corporate Woods
Vernon Hills, Illinois

1st Floor: 97,134 Sq. Ft.
Office: 27,424 Sq. Ft.

TERMS:

Base Rent: \$8.95 Net
Escalation: 3% Per Year
RE Taxes: \$1.01 (2015 payable 2016)

HIGHLIGHTS:

- High Visibility Entry Site on Route 45
- Fully Air-Conditioned Warehouse
- Quality Finishes Throughout
- Large Open Office Area with 10 Foot Ceiling and Under Floor Conduit
- Potential for Building/Parking Expansion
- Energy Efficient T-8 Lighting Throughout Office and Warehouse
- 5,929 Sq. Ft. Mezzanine with Elevator not included in Square Footage
- Large Lunch Room and Locker Facilities
- Adjacent to New Vernon Hills Town Center
- Lower Lake County Taxes
- Located in Prestigious Corporate Woods

BUILDING DATA:

Ceiling Height: 24' Clear
Sprinkler System: Fully (ESFR)
Power: 1,200 Amps @ 480v
Off Street Parking: 235 Cars / Expandable

SHIPPING:

Truck Docks: 6 Interior (Split 4 + 2)

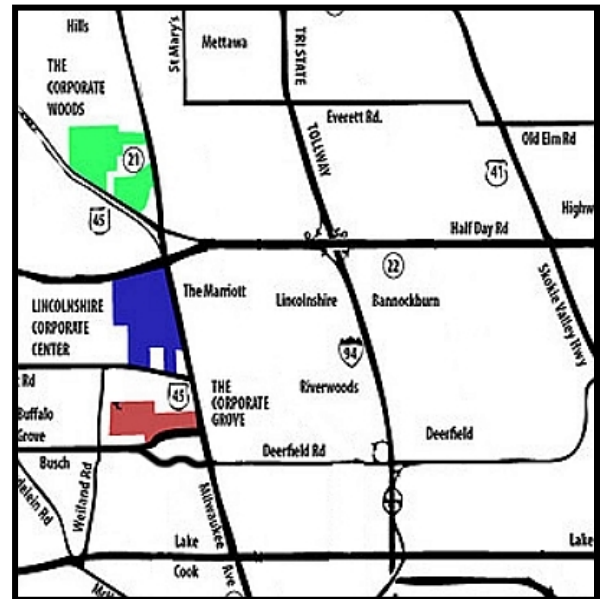

Exclusive Leasing and Management Agents



VAN VLISSINGEN AND CO.

One Overlook Point
Lincolnshire Corporate Center
Lincolnshire, Illinois 60069

847.634.2300

Chuck Lamphere, President
crl@vvco.com

Nick Panarese, Vice President
ndp@vvco.com

Above information is subject to verification and no liability for errors or omissions is assumed. Price is subject to change and listing withdrawn without notice. Members of this firm have an ownership interest in this property. © Copyright 2011 All Rights Reserved

1011 WOODLANDS PARKWAY

The Corporate Woods
Vernon Hills, Illinois

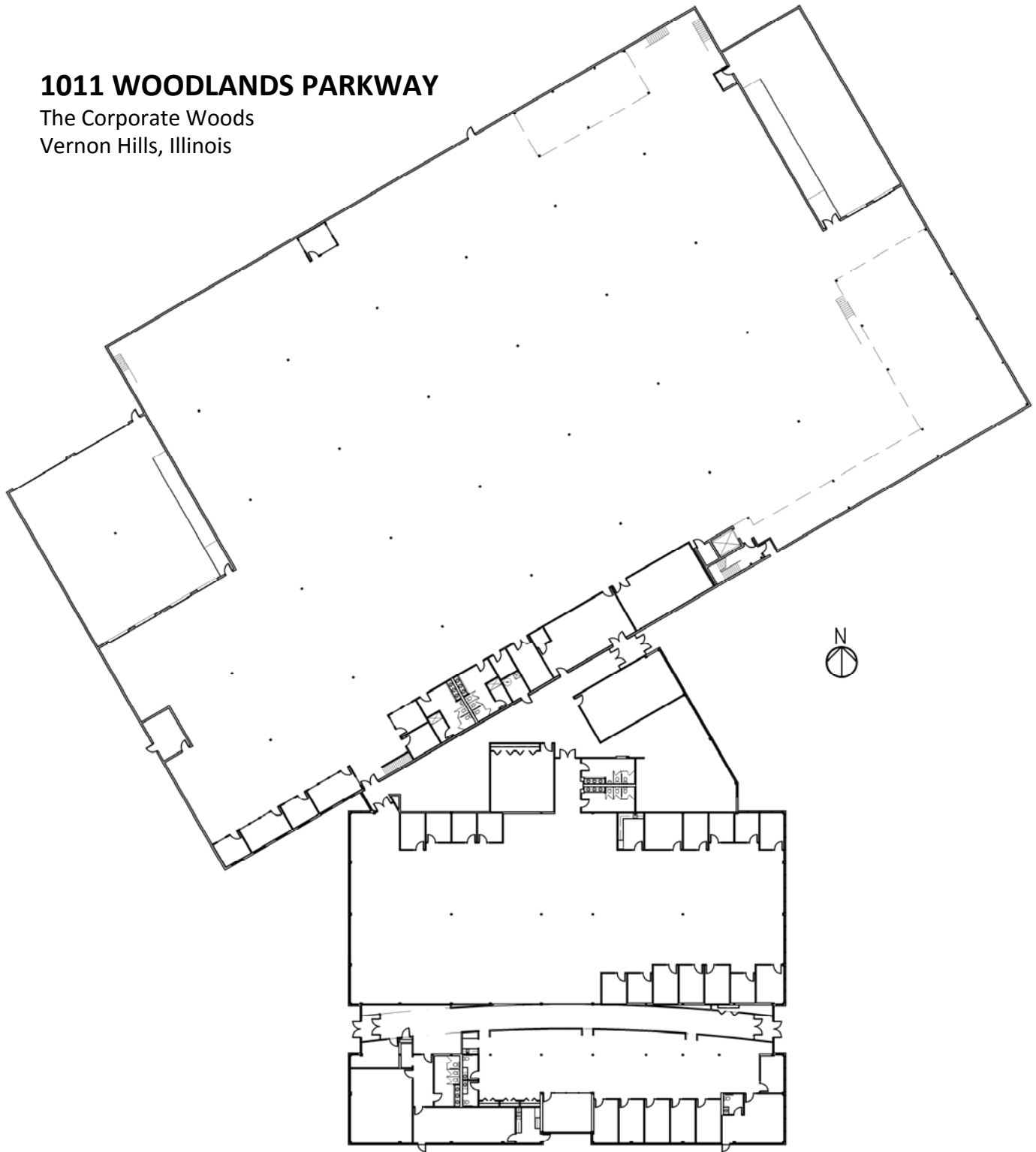

Exclusive Leasing and Management Agents



VAN VLISSINGEN AND CO.

One Overlook Point
Lincolnshire Corporate Center
Lincolnshire, Illinois 60069

847.634.2300

Chuck Lamphere, President
crl@vvco.com

Nick Panarese, Vice President
ndp@vvco.com

Above information is subject to verification and no liability for errors or omissions is assumed. Price is subject to change and listing withdrawn without notice. Members of this firm have an ownership interest in this property. © Copyright 2011 All Rights Reserved